

# S-5!™

The Right Way!

## Installation Instructions

The S-5-K, S-5-R, and S-5-T2 are made for Klip Rib and batten seam profiles. Mate the clamp halves and start the M8 bolts. Thread bolts until bolt end is just flush with the outside surface of the straight (unflanged) side. Place clamp assembly over the seam and force down until clamp snaps over seam. Position clamp appropriately on seam, then close clamp using a locking C-clamp.

Using a hand ratchet or electric tool (13mm), tighten M8 bolts by alternating back and forth between bolts until clamp is closed completely. Remove locking C-clamp.

For maximum holding strength, setscrews should be tensioned and re-tensioned as the seam material compresses. Screw tension should be verified using a calibrated torque wrench between 160 and 180 inch pounds when used on 22ga steel and between 130 and 150 inch pounds for all other metals and thinner gauges of steel. Consult the S-5! website at [www.S-5.com](http://www.S-5.com) for published data regarding holding strength.

For extra strength, prior to mating the clamp halves, place a small piece of butyl tape on the inside of the flanged clamp wall, covering the lower hole as shown. Once clamp is in place and M8 bolts have been tightened, fasten clamp to seam using a sheet metal screw.

S-5!™ Warning! Please use these products responsibly! Visit our website or contact your S-5!™ distributor for detailed installation instructions and load test results.

Copyright 2007, Metal Roof Innovations, Ltd. S-5!™ products are patented by Metal Roof Innovations, Ltd.

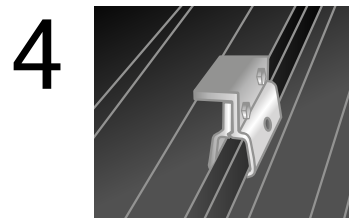
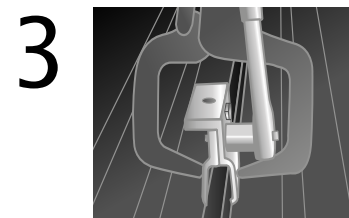
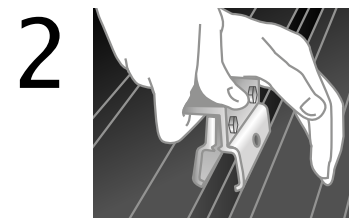
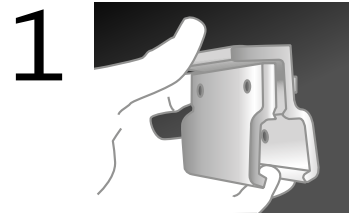

**S-5-K, S-5-R, and S-5-T2 Clamps**

Attach anything to standing seam metal roofs  
without piercing the panel!

888-825-3432

[www.S-5.com](http://www.S-5.com)