

BoxBolt® Installation Instructions

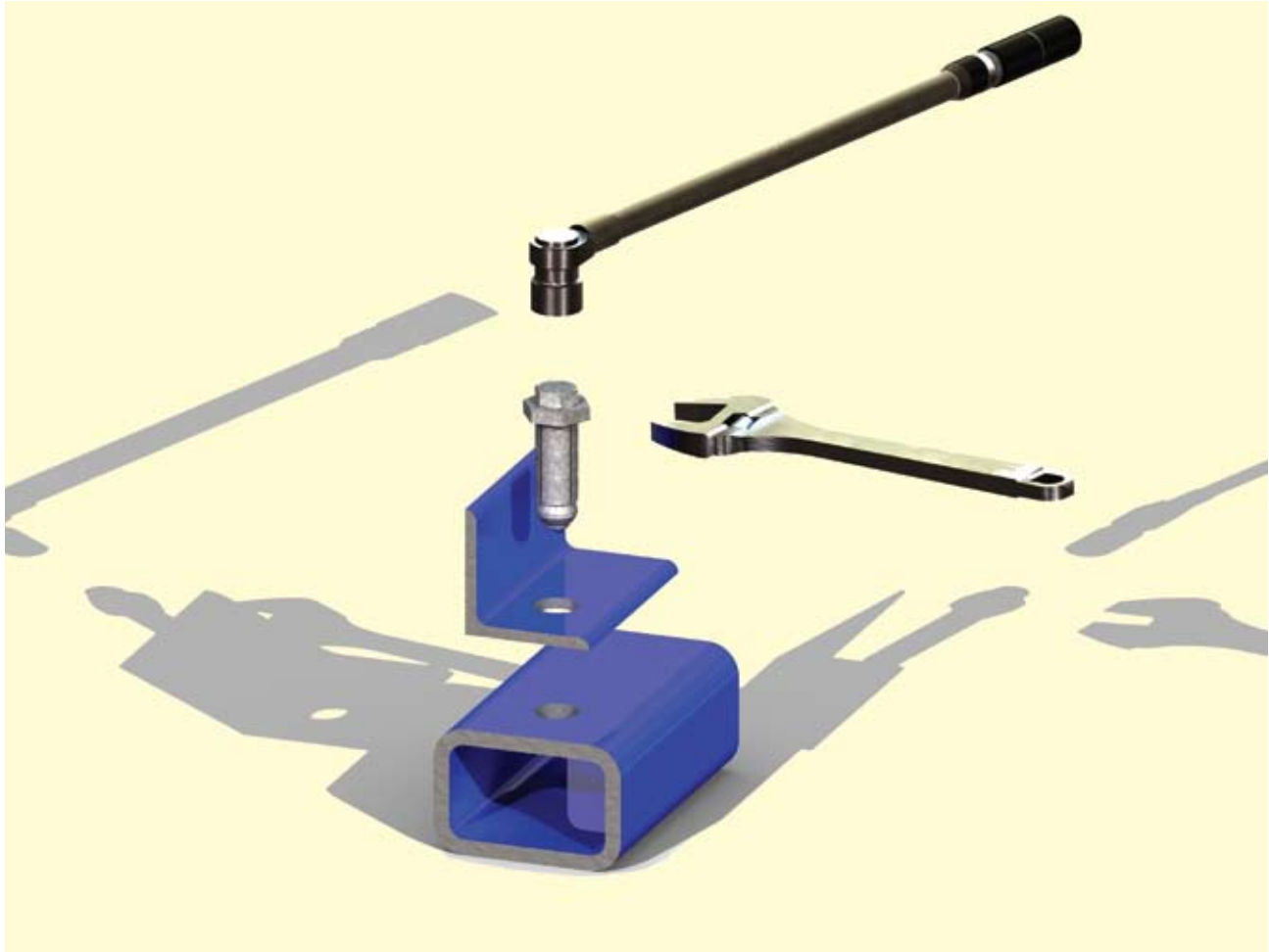

STEP 1: Align the holes in the bracket to be secured with the pre-drilled hole in the structural tube. Insert the BoxBolt through both pieces of steel until the underside of the shoulder is flush with the outside of the steel.

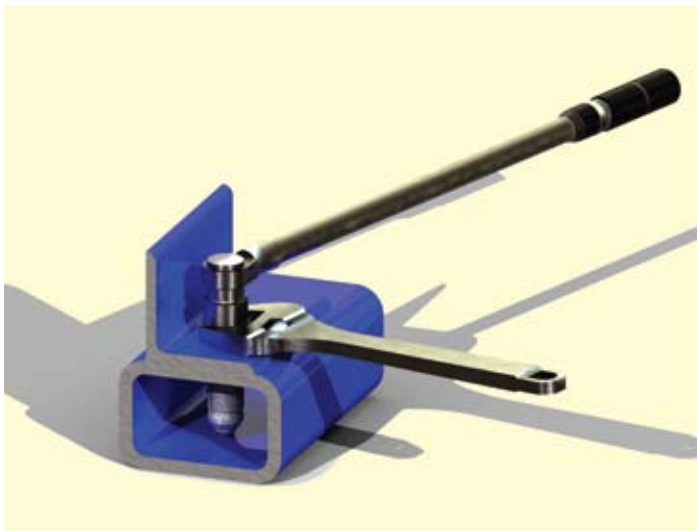

STEP 2: Hold the hexagon shoulder of the BoxBolt with an open ended wrench. Use an impact wrench or ratchet to tighten the core bolt.

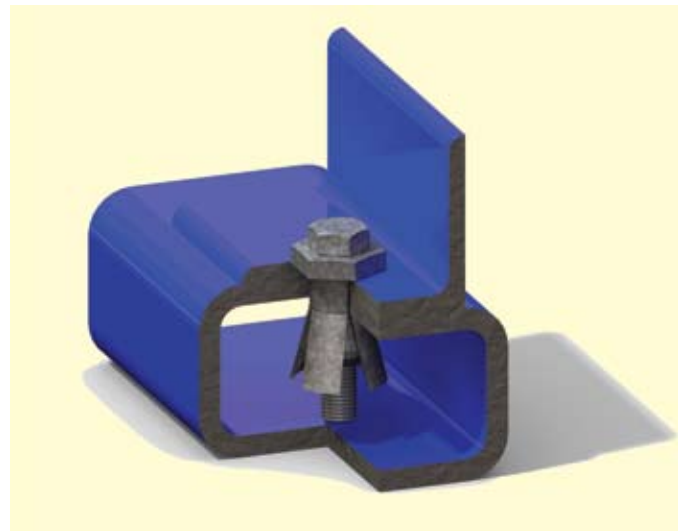

STEP 3: Remove the open ended wrench and check to ensure that the core bolt is tightened to the recommended torque.