

Simple Table

Basic Table Frame

Kit Instructions

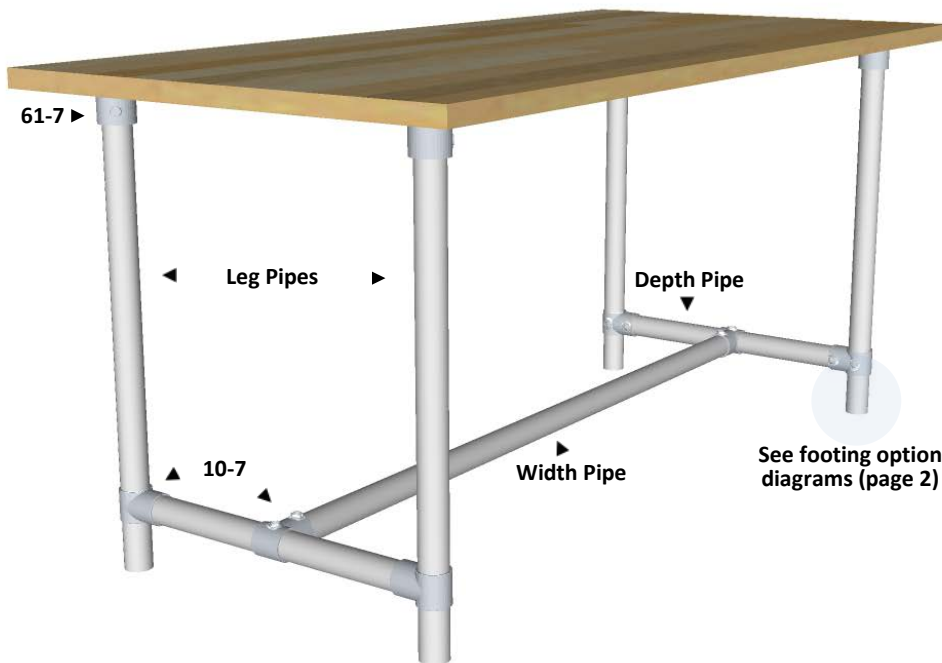

Parts

Standard Table Parts

Qty Part

4	61-7 Flanges
6	10-7 Single Socket Tees
4	Leg Pipes
2	Depth Pipes
1	Width Pipe

Footing Options

Plugs	4	133-7
Flanges	4	61-7
Casters	2	3" Caster w/ Brake
	2	3" Caster w/o Brake

Tools

- Allen Key (included)
- Screw Driver
- Hammer (for plugs)
- Crescent Wrench (for casters)
- Level

Hardware Needed

- #10 x 3/4" Flat Head Wood Screws

Basic Installation Instructions

1. Confirm that you have all the required parts.
2. Assemble the parts according to the enclosed diagram.
3. When you initially assemble the unit, loosely tighten the fitting set screws. After the unit is completely assembled, fully tighten all set screws.
4. If installing plugs, place cloth over plug and hammer into place.

Troubleshooting

If the table seems wobbly, loosen the set screws and adjust the pipes until the table is stable.

Questions or Installation Problems?

Customer Service | 1.888.527.2278

Simple Table

Basic Table Frame

Kit Instructions

Step by Step Instructions

- 1) Start by attaching the 10-7 Tees to end of Width Pipe.
- 2) Now slide each Depth Pipe through the 10-7 Tees on Width Pipe.
- 3) Attach the remaining 10-7 Tees to the ends of Depth Pipe.
- 4) Slide Leg Pipes into the 10-7 Tees and leave about 3 inches sticking out. Tighten setscrews lightly.
- 5) Attach the 61-7 flanges on the top of Leg Pipes.
- 6) Place your desktop on the ground, with the bottom facing up.
- 7) Flip the pipe frame over so that the 61-7 flanges are now lying flat on the bottom of the desktop.
- 8) Move the legs of the frame on the desktop until the 61-7 flanges are about 4 inches from each edge.
- 9) Attach the 61-7 flanges to the desktop with the #10 x 3/4" wood screws (screws not provided).
- 10) Attach the appropriate footing to bottom of Leg Pipes.
- 11) Turn the desk right side up! You are done! You can adjust the individual fittings to make sure that everything is level and square.

Post Footing



Flange Footing

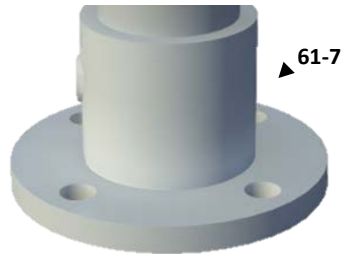

Caster Footing



Caster — The caster mount is tightened with a wrench until the rubber sleeve snugly fits in the pipe. Once the sleeve is inserted into the pipe, tighten with a wrench until the caster cannot be pulled out of the pipe.

Questions or Installation Problems?